

1 / 10 SCALE RC 4WD HIGH PERFORMANCE DRIFT CAR

XXX-D VIP

1 / 10 EP DRIFT CAR CHASSIS KIT

XXX-D VIP (FM)

ON ROAD USE ONLY

FULL BALL BEARINGS

Wheelbase : Standard 257mm (adjustable)
Tread : Standard 186mm (adjustable)
Gear ration : 1.89 (34T/18T)
Caster : 4, 7, 10, 14 degrees variableness
Camber : 0 to -12 degrees

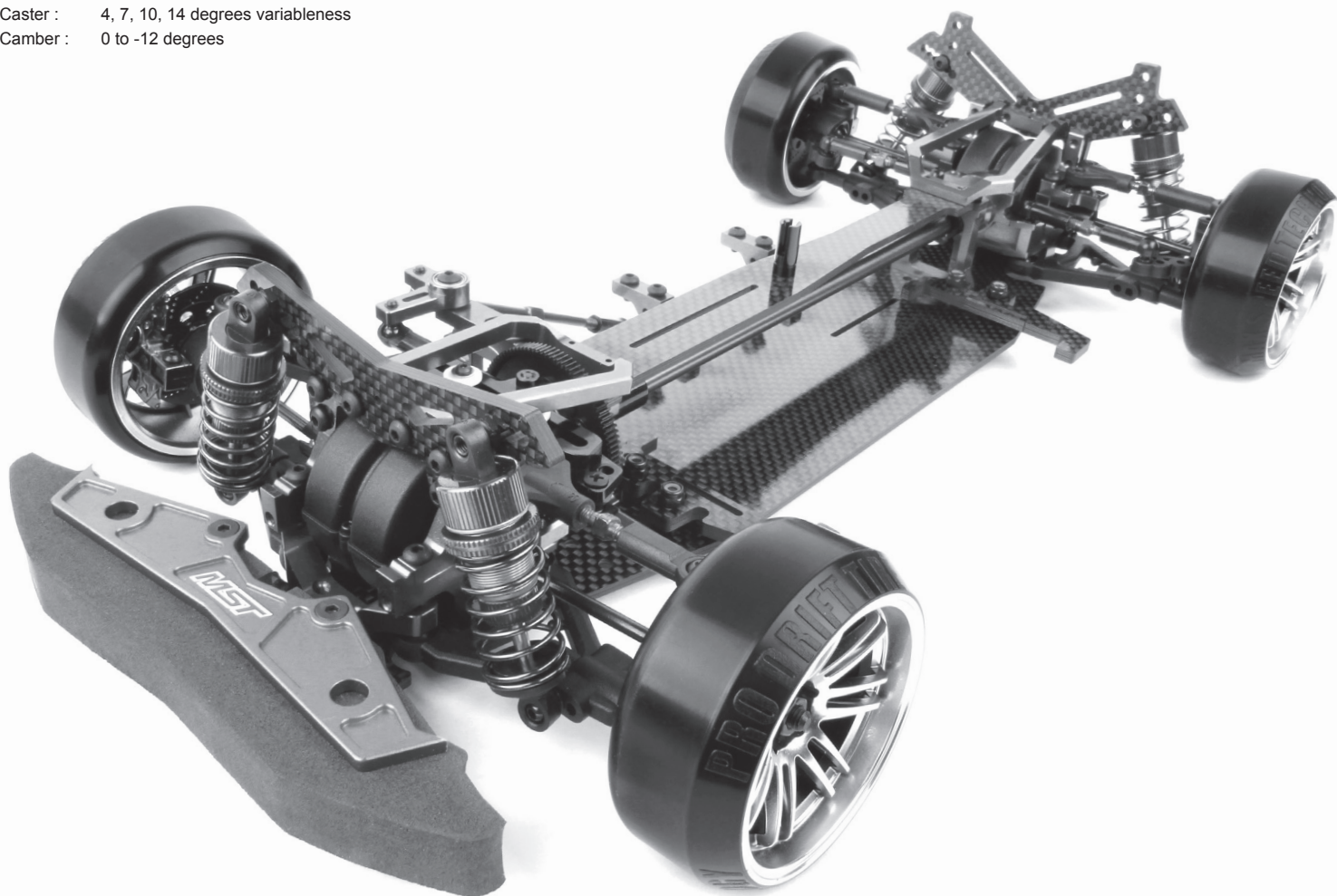

※ Specification are subject to change without notice.

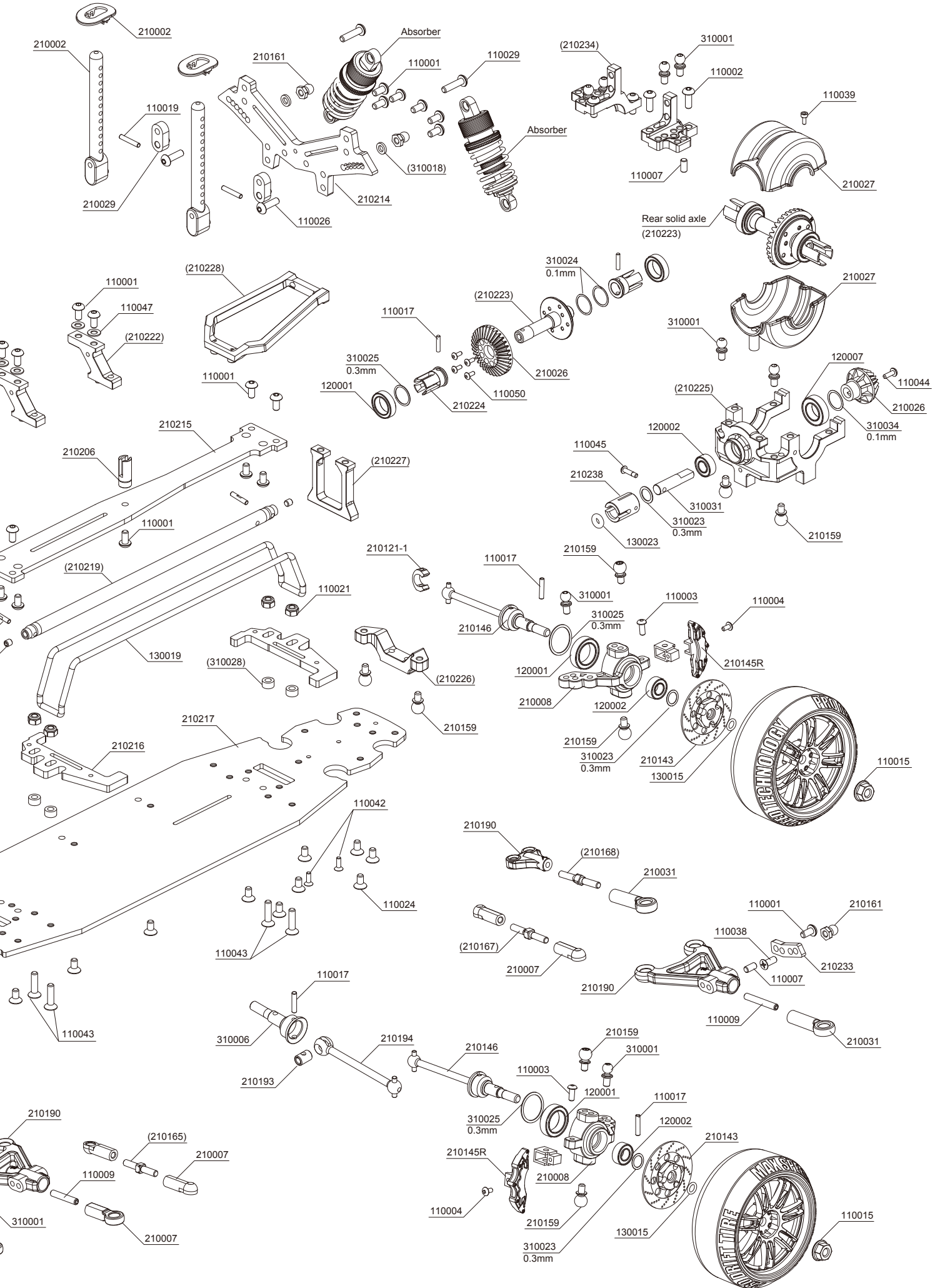

PARTS

A PARTS

M3×12 Screw ×2
110029 半圓頭螺絲

M3×10 Screw ×6
110026 半圓頭螺絲

M3×8 Screw ×8
110002 半圓頭螺絲

M3×6 Screw ×29
110001 半圓頭螺絲

M3×5 Screw ×4
110049 半圓頭螺絲

M3×12 Screw ×4
110043 沉頭螺絲

M3×8 Screw ×9
110005 沉頭螺絲

M3×6 Screw ×16
110024 沉頭螺絲

M2×6 Screw ×4
110042 沉頭螺絲

M3×20 Screw ×4
110009 止付螺絲

2×11.8 Shaft ×4
110019 插銷

2×9.8 Shaft ×3
110046 插銷(剖溝)

2×9.8 Shaft ×11
110017 插銷

M3×6 Screw ×6
110007 公制六角止付螺絲

M3×3 Screw ×3
110035 公制六角止付螺絲

3x5x0.1mm Spacer ×2
310020 墊片

3x5x0.3mm Spacer ×2
310021 墊片

3x5.5x3.0mm Alum spacer ×4
310028 鋁墊片

3x5.5x1.0mm Alum spacer ×2
310018 鋁墊片

3X6X0.5mm Spacer ×6
110047 墊片

3X8X0.5mm Spacer ×1
110048 墊片

R6 R-clip ×5
110016 R形扣

2.6×10 Screw ×1
110025 自攻半圓頭螺絲

M2.5×6 Screw ×4
110003 半圓頭螺絲

M2×8 Screw ×3
110045 半圓頭螺絲

M2×6 Screw ×6
110044 半圓頭螺絲

M2×5 Screw ×4
110050 半圓頭螺絲

M2×4 Screw ×6
110004 半圓頭螺絲

M1.6×4 Screw ×2
110039 有頭螺絲

M3×7 Screw ×2
110038 十字扁頭螺絲

M3×5 Screw ×3
110051 十字扁頭螺絲

4.8×4.5 Ball connector ×20
310001 球頭螺絲

5.8×4 Ball connector ×16
210159 球頭螺絲

4.8mm Ball connector nut ×8
210161 球頭螺帽

M3 Lock Nut ×4
110021 防鬆螺帽

M4 Flange nut ×4
110015 凸緣螺帽

5x7x0.3mm Spacer ×6
310023 墊片

10x12x0.1mm Spacer ×4
310024 墊片

10x12x0.3mm Spacer ×4
310025 墊片

8x10x0.1mm Spacer ×2
310034 墊片

B PARTS

10×15 Ball bearing ×8
120001 培林

8×14 Ball bearing ×2
120007 培林

3×6 Ball bearing ×4
120005 培林

5×10 Ball bearing ×7
120002 培林

3.5×1 O-ring ×4
130015 O形環

5×8 Ball bearing ×2
120003 培林

O-ring P3 (black) ×3
O形環 P3 (黑)
130023

Battery O-ring ×1
電池O環
130019

Bumper (B) ×1
防撞泡棉 (B)
130020

Damper oil 150# ×1
避震油 150#
130022

Tools ×1
工具包
130011

Bumper ×1
泡棉雙面膠
130006

Black grease ×1
黑色油膏
130008

C PARTS

210002

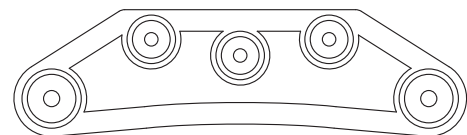

D PARTS

One way joint ×2
單向接杯
210103

XXX Alum one way unit (FM) ×1
XXX 鋁合金前單組
210220

PARTS

E PARTS

XXX Alum spool unit ×1
XXX 鋁合金直軸組
210223

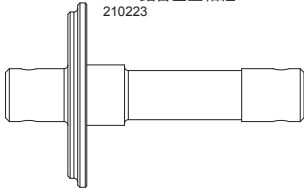

Swing Shaft Protector ×2
直軸軸套
210121-1



XXX Spool joint ×2
XXX 直軸接杯
210224

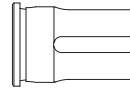

G PARTS ×4

210190

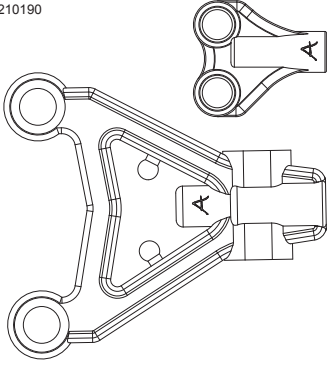

H PARTS ×2

210007

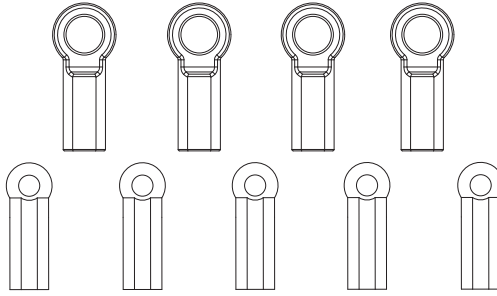

I PARTS ×2

210008

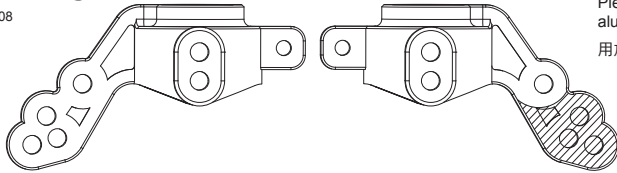

Please cut off the diagonal place for alum front upright using.
用於前輪座時請將斜線處切除

J PARTS

3×68 Alum turn-buckle shaft ×1
210218 鋁合金可調拉桿



3×25 Steel turn-buckle shaft ×4
210168 鋼可調拉桿

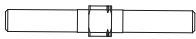

3×25 Alum turn-buckle shaft ×3
210167 鋁製可調拉桿

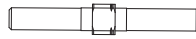

3×20 Alum turn-buckle shaft ×2
210165 鋁製可調拉桿

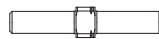

L PARTS

XXX Alum connector ×2
XXX 鋁合金連結架
210228

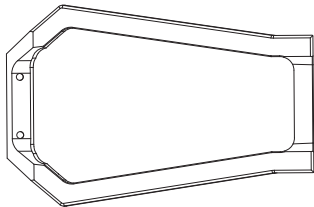

XXX Alum vertical short servo mount ×2
XXX 鋁合金立式短型伺服機座
210222

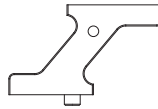

XXX Alum upper deck support ×1
XXX 鋁合金連結座
210227

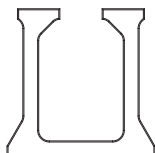

XXX Alum motor mount set ×1
XXX 鋁合金馬達架組
210229

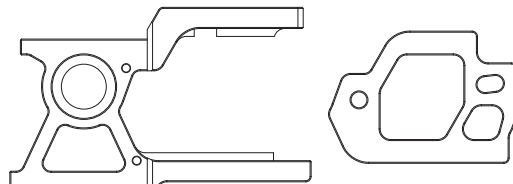

F PARTS

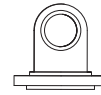

Damper cap ×4
避震器上球座
210005



Damper retainer ×4
避震器下座
210005

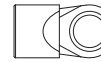

Damper adjuster ×4
避震器下拉桿頭
210005

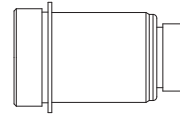

Alum damper cylinder ×4
鋁合金避震筒身
210151

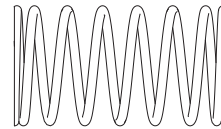

Coil spring set 28mm ×1
避震彈簧組28mm
210144

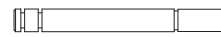

Piston rod ×4
避震軸心
310008



Spring retainer ×4
避震器調整環
310004

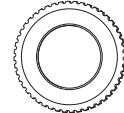

Cylinder cap ×4
避震器上蓋
310003

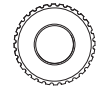

Rod guide cap ×4
避震器下蓋
310005



Piston spacer set ×4
避震器活塞墊片組
210235

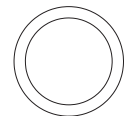

11.5X1.5 O-ring ×4
130002 O-ring



Damper O-ring P3 (red) ×4
阻尼器O環 P3 (紅)
130001



6.5×2 Sponge ×5
130021 泡棉



Oil seal ×4
避震氣室
130004



E-clip ×8
E形扣
110013

PARTS

K PARTS

Carbon damper support extension ×2
 碳纖維避震支點延伸片
 210233



XXX Carbon battery holder set ×2
 XXX 碳纖維電池座組
 210216

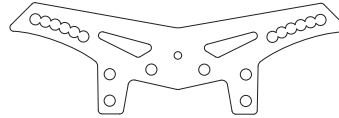
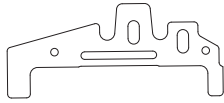

XXX Carbon front damper stay ×1
 XXX 碳纖維前避震架
 210213

XXX Carbon upper deck set ×1
 XXX 碳纖維二樓板組
 210215

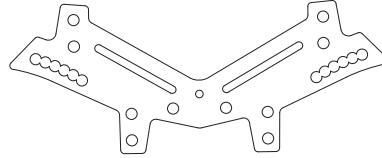
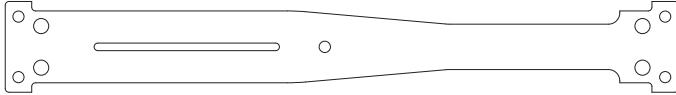

XXX Carbon rear damper stay ×1
 XXX 碳纖維後避震架
 210214

XXX Carbon lower deck set ×1
 XXX 碳纖維底盤組
 210217

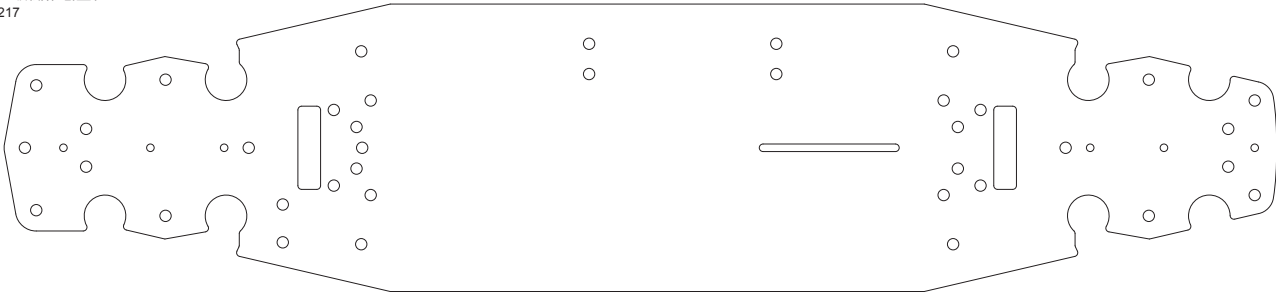

M PARTS

Brake calipers (red) ×1
 煞車卡鉗(紅)
 210145R

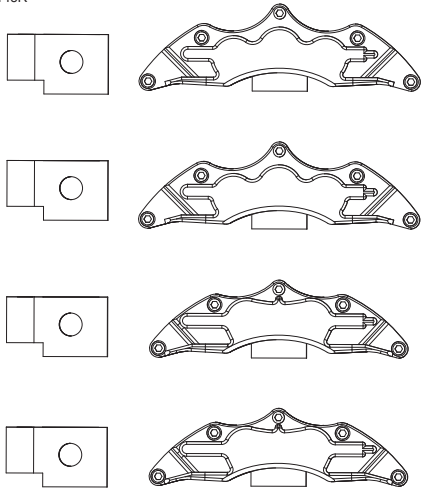

N PARTS

XXX Alum spur gear holder ×1
 XXX 鋁合金大齒盤座
 210230

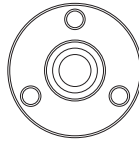

XXX Alum steering arm set ×1
 XXX 鋁合金大轉向滑軌組
 210232

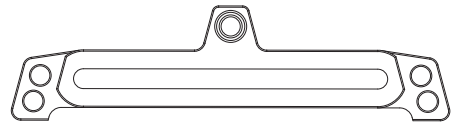

Alum antenna pipe mount (generalized) ×1
 鋁合金天線管座(通用型)
 210206



XXX Alum gear box cover ×2
 XXX 鋁合金齒箱上蓋
 210234

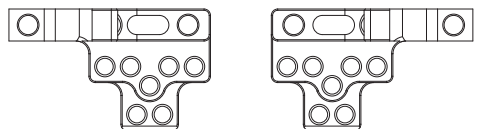

XXX Alum FM steering arm set ×1
 XXX 鋁合金前置轉向搖臂組
 210231

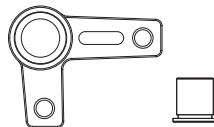

XXX Alum gear B box ×2
 XXX 鋁合金傘齒箱
 210225

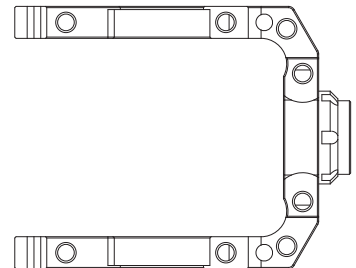

Alum Wheel Hubs (brake disc shaped) ×1
 鋁合金剎車碟六角輪座
 210143

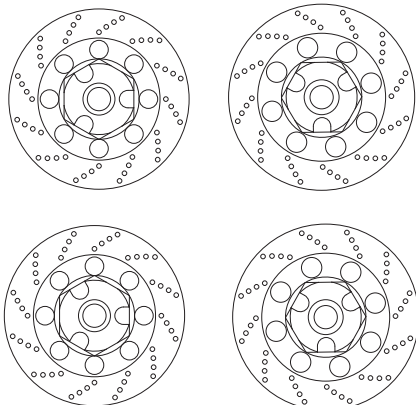

XXX Alum lower arm mount ×2
 XXX 鋁合金下搖臂座
 210226

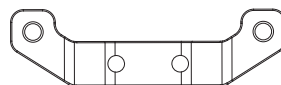

Alum bumper support ×1
 鋁合金防撞板上蓋
 210142



PARTS

O PARTS

Bevel gear set (34-18) ×1
傘齒組 (34-18)
210026

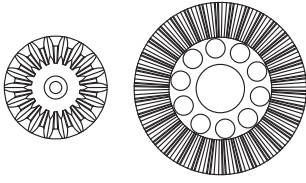

Bevel gear set (40-16) ×1
傘齒組 (40-16)
210025

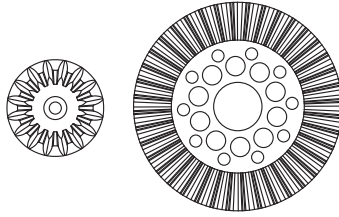

Spur gear (64P) ×1
大直齒 (64P)
164100~164106

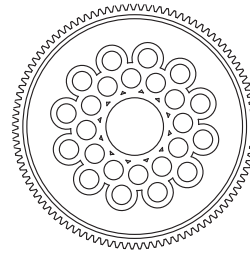

	Gear Ratio (Final Drive 34T / 18T<1.89>)			
	100T	102T	104T	106T
20T				10.01
21T				9.53
22T			8.93	9.10
23T			8.54	8.71
24T		8.03	8.19	8.34
25T		7.71	7.86	8.01
26T	7.27	7.41	7.56	7.70
27T	7.00	7.14	7.28	7.42
28T	6.75	6.88	7.02	7.15
29T	6.51	6.64	6.77	6.90
30T	6.30	6.42	6.55	6.67
31T	6.09	6.22	6.34	
32T	5.90	6.02	6.14	
33T	5.72	5.84		
34T	5.56	5.67		
35T	5.40			
36T	5.25			

P PARTS

5.8×26 Adjuster set ×1
210031 拉桿頭組

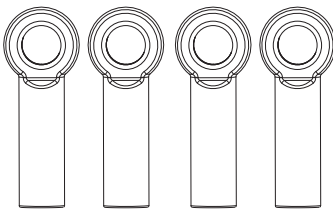

Vertical servo mount set ×1
立式伺服機座組
210028

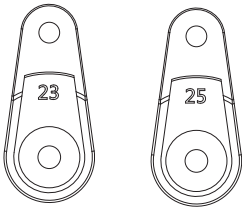
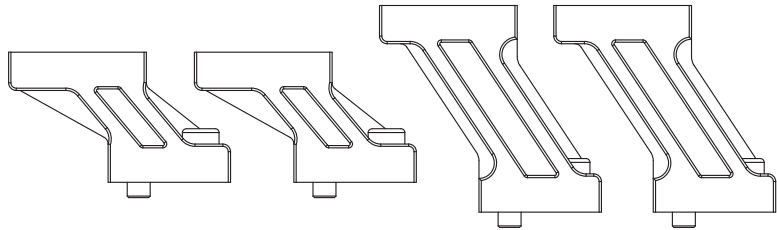

Servo horn set ×1
伺服機片組
210032

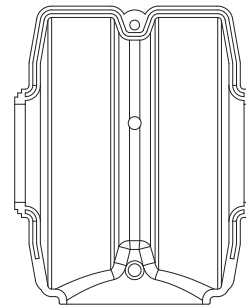
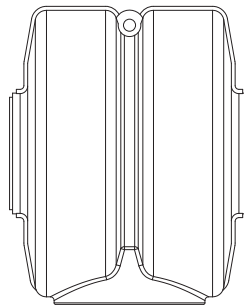

Gear dust cover ×2
防塵殼組
210027

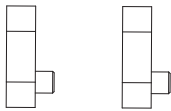

Body post extension mount 4mm ×1
車殼柱延伸座 4mm
210029

Q PARTS

XXX Alum propeller shaft ×1
XXX 鋁合金中傳軸
210219



Bevel gear - short abor ×1
齒傘短軸
310031



Bevel gear - long abor ×1
齒傘長軸
310030



XXX Alum propeller shaft joint ×2
XXX 鋁合金中軸接杯
210238

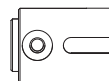

Rail post ×2
滑軌支柱
310029

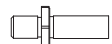

Wheel axle ×4
萬向接杯
310006

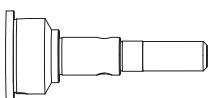

Cross joint ×4
連接軸
210193



Steel CVD universal shaft ×4
鋼製 CVD 傳動軸
210194

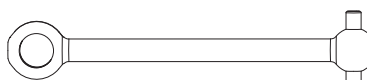

PARTS CODE

110001	Round head socket screw M3×6 (10)	120003	Ball bearing 5×8 (4)	210144	Coil spring set 28mm (8)	210225R	XXX Alum gear B box (red)
110002	Round head socket screw M3×8 (10)	120005	Ball bearing 3×6 (4)	210144-1	Coil spring set 28mm (hard) (silver) (2)	210226R	XXX Alum lower arm mount (red)
110003	Round head socket screw M2.5×6 (6)	120007	Ball bearing 8×14 (2)	210144-2	Coil spring set 28mm (medium) (gold) (2)	210227R	XXX Alum upper deck support (red)
110004	Round head socket screw M2×4 (6)	130001	Damper O-ring P3 (red) (10)	210144-3	Coil spring set 28mm (soft) (red) (2)	210228R	XXX Alum connector (red)
110005	Countersunk hex head screw M3×8 (10)	130002	O-ring 11.5×1.5 (4)	210144-4	Coil spring set 28mm (super soft) (white) (2)	210229R	XXX Alum motor mount set (red)
110007	Drub screw M3×6 (6)	130004	Oil seal (4)	210145R	Brake calipers (red) (4)	210230R	XXX Alum spur gear holder (red)
110009	Drub screw M3×20 (6)	130006	Double sided tape (5)	210146	Steel CVD universal shaft set (2)	210231R	XXX Alum front steering arm set (red)
110013	E-clip E2.0 (10)	130007	Antenna pipe (2)	210151	Alum damper cylinder (4)	210232	XXX Alum steering arm set
110015	Flange nut M4 (4)	130008	Black grease	210159	5.8x4mm ball connector (4)	210233	Carbon damper support extension
110016	R-clip R6 (10)	130011	Tools	210161	4.8mm ball connector nut (4)	210234R	XXX Alum gear box cover (red)
110017	Shaft 2×9.8 (10)	130015	O-ring 3.5×1 (10)	210165R	Alum turn-buckle shaft	210235	Piston spacer set
110019	Shaft 2×11.8 (5)	130019	Battery O-ring	210167R	Alum turn-buckle shaft	210238	XXX Alum propeller shaft joint (2)
110021	Lock Nut M3 (5)	130020	Bumper (B)	210168R	3x25mm (red) (2)	210240	Rail spacer (2)
110024	Countersunk hex head screw M3×6 (10)	130021	6.5×2 sponge (10)	210167R	Alum turn-buckle shaft	310001	Ball connector 4.8 X 4.5 (5)
110025	Taping screw 2.6×10 (6)	130022	Damper oil 150#	210168R	3x25mm (red) (2)	310003R	Cylinder cap (red) (2)
110026	Round head socket screw M3×10 (10)	130023	O-ring P3 (black) (10)	210190	Reinforced suspension arm set (2)	310004R	Spring retainer (red) (2)
110029	Round head socket screw M3×12 (6)	210002	C PARTS	210193	Cross joint (4)	310005R	Rod guide cap (red) (2)
110035	Drub screw M3×3 (6)	210005	F PARTS	210194	Steel CVD universal shaft (2)	310006	Wheel axle (2)
110038	Flat head screw M3×7 (10)	210007	H PARTS	210206	Alum antenna pipe mount (generalized)	310008	Piston rod (4)
110039	Cap screw M1.6×4 (10)	210008	I PARTS	210213	XXX Carbon front damper stay	310018R	Alum spacer 3x5.5x1.0 (red)
110042	Countersunk hex head screw M2×6 (6)	210025	Bevel gear set (40-16)	210214	XXX Carbon rear damper stay	310020	Spacer 3×5×0.1mm (8)
110043	Countersunk hex head screw M3×12 (10)	210026	Bevel gear set (34-18)	210215	XXX Carbon upper deck set	310021	Spacer 3×5×0.3mm (8)
110044	Round head socket screw M2×6 (6)	210027	Bevel diff dust cover set	210216	XXX Carbon battery holder set	310024	Spacer 10×12×0.1mm (8)
110045	Round head socket screw M2×8 (6)	210029	Body post extension mount 4mm	210217	XXX Carbon lower deck set	310025	Spacer 10×12×0.3mm (8)
110046	Shaft 2×9.8 (8)	210031	Adjuster set 5.8×26	210218R	Alum turn-buckle shaft 3x68mm (red)	310028R	Alum spacer 3x5.5x3.0 (red)
110047	Spacer 3×6×0.5 (8)	210032	Servo horn set	210219R	XXX Alum propeller shaft (red)	310029	Rail post (2)
110048	Spacer 3×8×0.5 (8)	210108R	Alum turn-buckle shaft 3x28mm (red) (2)	210220R	XXX Alum one way unit (FM) (red)	310030	Bevel gear - long abor
110049	Round head socket screw M3×5 (10)	210121-1	Swing Shaft Protector (4)	210222R	Alum vertical short servo mount (red)	310031	Bevel gear - short abor
110050	Round head socket screw M2×5 (6)	210121-1	4mm Turnbuckle wrench (1)	210223R	XXX Alum spool unit (red)		
110051	Flat head screw M3×5 (5)	210137	4mm Turnbuckle wrench (1)	210224	XXX Spool joint		
120001	Ball bearing 10×15 (4)	210142R	Alum bumper support (red)				
120002	Ball bearing 5×10 (4)	210143	Alum Wheel Hubs (brake disc shaped) (4)				

OPTION PARTS CODE

210118R	Alum upright (red) (2)	210154-4	Coil spring 21mm (super soft) (white) (2)	210237	XXX Alum RM servo mount set
210145	Brake calipers (4)	210163	Alum hex wheel hubs (4)	210239R	Alum front upright (red) (2)
210145B	Brake calipers-blue (4)	210205	DK Coil spring set 30mm	210242R	XXX-D VIP Rear motor mount conversion kit (red)
210145GD	Brake calipers-gold (4)	210205-1	DK Coil spring 30mm (hard) (silver) (2)		
210154	Coil spring set 21mm (8)	210205-2	DK Coil spring 30mm (medium) (gold) (2)		
210154-1	Coil spring 21mm (hard) (silver) (2)	210205-3	DK Coil spring 30mm (soft) (red) (2)		
210154-2	Coil spring 21mm (medium) (gold) (2)	210205-4	DK Coil spring 30mm (super soft) (white) (2)		
210154-3	Coil spring 21mm (soft) (red) (2)	210221R	XXX Alum one way unit (RM) (red)		

部品編號

110001	公制六角半圓頭螺絲-M3×6 (10)	120003	培林 5×8 (4)	210144	避震彈簧組28mm (4種硬度)	210225R	XXX-鋁合金傘齒箱 (紅)
110002	公制六角半圓頭螺絲-M3×8 (10)	120005	培林 3×6 (4)	210144-1	避震彈簧28mm (硬) (銀) (2)	210226R	XXX-鋁合金下搖臂座 (紅)
110003	公制六角半圓頭螺絲-M2.5×6 (6)	120007	培林 8×14 (2)	210144-2	避震彈簧28mm (中) (金) (2)	210227R	XXX-鋁合金連結座 (紅)
110004	公制六角半圓頭螺絲-M2×4 (6)	130001	阻尼器O環-P3 (紅) (10)	210144-3	避震彈簧28mm (軟) (紅) (2)	210228R	XXX-鋁合金連結架 (紅)
110005	公制六角沉頭螺絲-M3×8 (10)	130002	O環-11.5×1.5 (4)	210144-4	避震彈簧28mm (超軟) (白) (2)	210229R	XXX-鋁合金馬達架組 (紅)
110007	公制六角止付螺絲-M3×6 (6)	130004	避震氣室 (4)	210145R	煞車卡鉗 (電鍍紅) (4)	210230R	XXX-鋁合金大齒盤座 (紅)
110009	公制六角止付螺絲-M3×20 (6)	130006	泡棉雙面膠 (5)	210146	大角度CVD傳動軸 (2)	210231R	XXX-鋁合金前置轉向搖臂組 (紅)
110013	E扣-2.0 (10)	130007	天線管 (2)	210151	鋁合金避震筒身 (4)	210232	XXX-鋁合金大轉向滑軌組
110015	凸緣螺帽-M4 (4)	130008	黑色油膏	210159	5.8×4mm球頭螺絲 (4)	210233	碳纖維避震支點延伸片
110016	R銷-6 (10)	130011	工具包	210161	4.8mm外六角球頭螺帽 (4)	210234R	XXX-鋁合金齒箱上蓋 (紅)
110017	插銷-2×9.8 (10)	130015	O環-3.5×1mm (10)	210165R	鋁製可調拉桿	210235	避震器活塞墊片組
110019	插銷-2×11.8 (5)	130019	電池O環	210167R	3×20mm (紅) (2)	210238	XXX-鋁合金中軸接杯 (2)
110021	防鬆螺帽-M3 (5)	130020	XXX-防撞泡棉	210167R	鋁製可調拉桿	210240	滑軌墊片 (2)
110024	公制六角沉頭螺絲-M3×6 (10)	130021	6.5×2 泡棉 (10)	210168R	3×25mm (紅) (2)	310001	內六角公球頭4.8×5 (5)
110025	自攻六角半圓頭螺絲-2.6×10 (6)	130022	避震油150#	210168R	鋼可調拉桿	310003R	避震器上蓋 (紅) (2)
110026	公制六角半圓頭螺絲-M3×10 (10)	130023	O環-P3 (黑) (10)	210190	3×25mm (紅) (2)	310004R	避震器調整環 (紅) (2)
110029	公制六角半圓頭螺絲-M3×12 (6)	210002	C部品	210193	強化擺臂組 (2)	310005R	避震器下蓋 (紅) (2)
110035	公制六角止付螺絲-M3×3 (6)	210005	F部品	210194	連接軸 (4)	310006	萬向接杯 (2)
110038	公制十字扁頭螺絲-M3×7 (10)	210007	H部品	210199	鋼製 CVD 傳動軸 (2)	310008	避震軸心 (4)
110039	公制六角有頭螺絲-M1.6×4 (10)	210008	I部品	210206	鋁合金天線管座 (通用型)	310018R	鉛墊片3×5.5×1.0mm (紅)
110042	公制六角沉頭螺絲-M2×6 (6)	210025	傘齒組 (40-16)	210213	XXX-碳纖維前避震架	310020	墊片3×5×0.1mm (8)
110043	公制六角沉頭螺絲-M3×12 (10)	210026	傘齒組 (34-18)	210214	XXX-碳纖維後避震架	310021	墊片3×5×0.3mm (8)
110044	公制六角半圓頭螺絲-M2×6 (6)	210027	傘差防塵殼組	210215	XXX-碳纖維二樓板組	310024	墊片10×12×0.1mm (8)
110045	公制六角半圓頭螺絲-M2×8 (半牙) (6)	210029	車殼柱延伸座 4mm	210216	XXX-碳纖維電池座組	310025	墊片10×12×0.3mm (8)
110046	插銷-2×9.8 (剖溝) (8)	210031	拉桿頭組 5.8×26	210217	XXX-碳纖維底盤組	310028R	鉛墊片3×5.5×3.0mm (紅)
110047	墊片-3×6×0.5 (8)	210032	伺服機片組	210218R	XXX-直軸接杯組	310029	滑軌支柱 (2)
110048	墊片-3×8×0.5 (8)	210108R	鋁可調拉桿	210219R	XXX-鋁合金中傳軸 (紅)	310030	齒傘長軸
110049	公制六角半圓頭螺絲-M3×5 (10)	210121-1	3×28mm(紅) (2)	210220R	XXX-鋁合金前單組 (前置) (紅)	310031	齒傘短軸
110050	公制六角半圓頭螺絲-M2×5 (6)	210137	直軸軸套 (4)	210222R	XXX-鋁合金前單組 (前置) (紅)		
110051	公制十字扁頭螺絲-M3×5 (5)	210142R	4mm拉桿板手	210223R	XXX-鋁合金直軸組 (紅)		
120001	培林-10×15 (4)	210143	鋁合金防撞板上蓋 (紅)	210224	XXX-直軸接杯組		
120002	培林-5×10 (4)		鋁合金剎車碟六角輪座(1車份)				

改裝品編號

210118R	鋁合金轉向座 (紅) (2)	210154-4	避震彈簧21mm (超軟) (白) (2)	210237R	XXX-鋁合金後置伺服機座組 (紅)
210145	煞車卡鉗 (無烤漆) (4)	210163	鋁合金六角輪座 (4)	210239	鋁合金前轉向座
210145B	煞車卡鉗 (電鍍藍) (4)	210205	DK避震彈簧組 30mm	210242R	XXX-D VIP後置套件 (紅)
210145GD	煞車卡鉗 (電鍍金) (4)	210205-1	DK避震彈簧 30mm (硬) (銀) (2)		
210154	避震彈簧組 21mm (8)	210205-2	DK避震彈簧 30mm (中) (金) (2)		
210154-1	避震彈簧21mm (硬) (銀) (2)	210205-3	DK避震彈簧 30mm (軟) (紅) (2)		
210154-2	避震彈簧21mm (中) (金) (2)	210205-4	DK避震彈簧 30mm (超軟) (白) (2)		
210154-3	避震彈簧21mm (軟) (紅) (2)	210221R	XXX-鋁合金前單組 (後置) (紅)		

